

3No semi-spherical recess in gravitational centreline of block for pin anchors.
(pin anchor is rated at 2.5 tonnes with a F.O.S. of 3)

20mm fillets to all external corners.

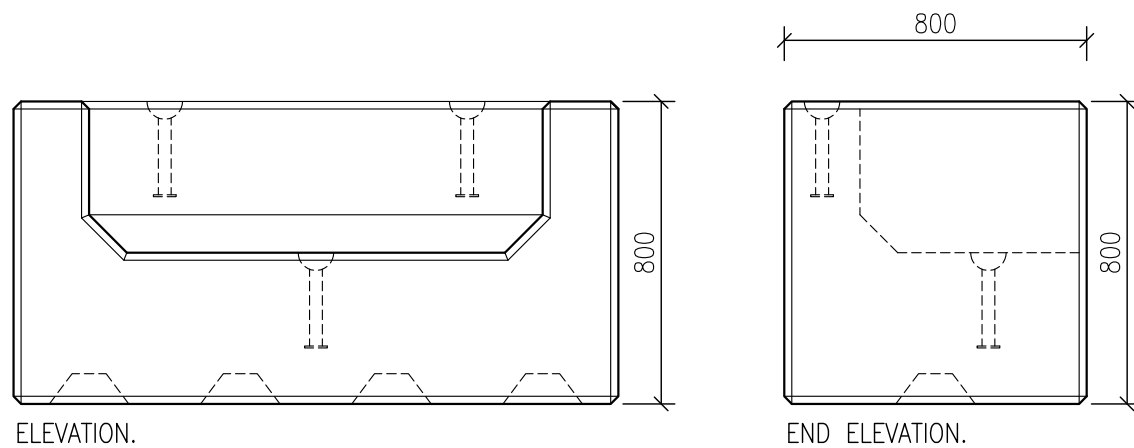
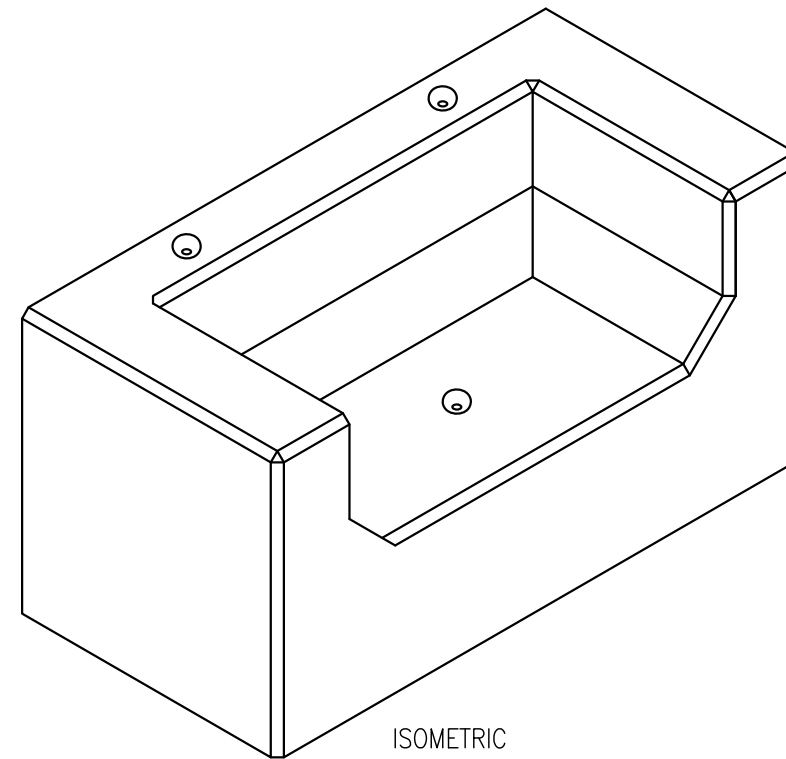
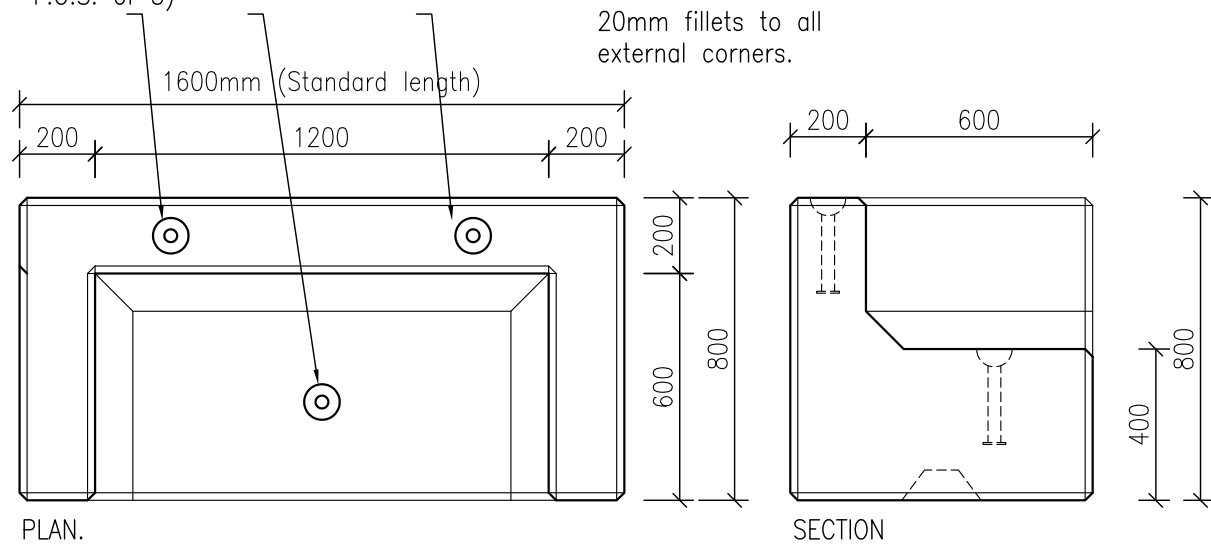

1. Handling.

- Volume of Standard block is 0.805m³ & a weight of 1892 kg (based on 2350 kg/m³)
- Lifting system is by means of a 180mm long spherical pin anchor rated at 5.0 tonnes with an F.O.S. of 3.
- Lifting is achieved by use of 3No 2.5T rated pin anchors ring clutch or combination ring clutch only and should comply with the Lifting Operation & Lifting Equipment Regulations 1998. (LOLER)

2. Concrete.

- Characteristic 28 day cube strength = 50 N/mm² min.
- Concrete is Class A1 Fire Resistant in accordance with clause 4.3.4.4 of EN 13369.

3. Manufacture.

- Manufactured to BS EN 13369:2013
- Tolerances to BS EN 13670:2009

4. Physical & Chemical Properties.

- Appearance: Grey in Colour.
- Other Chemical Properties: Not Applicable.

5. Manufacture Tolerances.

- Length: ± 5mm
- Width: ± 5mm
- Height: ± 5mm

• DO NOT SCALE USE FIGURED DIMENSIONS ONLY.
• ALL DIMENSIONS TO BE CHECKED ON SITE.
• A.P.C TO BE INFORMED OF ANY DISCREPANCIES BEFORE WORK PROCEEDS.

Revision:	Description:	Drawn By:	Date:
	PROGRESS PRINT		

Project:			Sheet Size:
TECHNICAL DATA SHEET.			A3
Title:			Drawing Scale:
Precast Concrete Seat.			1:20
			Drawn By:
			N.D.
Drawing No:	Revision:	Date:	Checked By:
APC-926		04/07/2023	



Civils Limited

Plot B, Old Dalby Business Park, Station Road,
Old Dalby, Melton Mowbray, LE14 3NJ
Tel. 01949 838647
Email. info@apccivils.co.uk www.apccivils.co.uk

© COPYRIGHT: APC Civils Ltd.
This drawing or any part thereof may not be copied or otherwise reproduced without the written permission of APC Civils Ltd.